

Test Jacks 4 mm System

Type

BU 20

4mm panel mount test jack, nickel plated brass, M6 thread screw/ solder terminal. max. panel thickness 13.5mm

Pin Diameter

4 mm

PART NO. / Housing color

930177000



BIL 20 / BIL 20 Au

4mm panel mount test jack, tin/ gold plated brass, M6 thread screw/ solder terminal, max. panel thickness 2mm

4 mm

Nickel Plated

- 930176100
- 930176101
- 930176102
- 930176103
- 930176104
- 930176105
- 930176106
- 930176107
- 930176109

Gold Plated

- 930176700
- 930176701
- 930176702
- 930176703
- 930176704
- 930176705
- 930176706
- 930176707
- 930176709

Technical Data

| | |
|---------------------------------|--------------------------------|
| Contact Type | jack Ø 4 mm |
| Connection Type | M6 thread, solder terminal |
| Voltage Rating | 30 VAC / 60 VDC |
| Measurement Category (IEC61010) | CAT I |
| Current Rating* | 16 A |
| Contact Resistance | 5 mOhm |
| Mounting Type | screw thread M6 |
| Material Specifications | |
| Jack Body | nickel plated brass |
| Contact Spring | nickel |
| Housing | - |
| Environmental Conditions | |
| Temperature Range | -25°C to +70 °C (-13 to 158°F) |
| Flamability Rating | |
| Housing | - |

| | |
|---------------------------------|--------------------------------|
| Contact Type | jack Ø 4 mm |
| Connection Type | M6 thread, solder terminal |
| Voltage Rating | 30 VAC / 60 VDC |
| Measurement Category (IEC61010) | CAT I |
| Current Rating* | 32 A |
| Contact Resistance | 5 mOhm |
| Mounting Type | screw thread M6 |
| Material Specifications | |
| Jack Body | tin / gold plated brass |
| Contact Spring | - |
| Housing | Polyamide |
| Environmental Conditions | |
| Temperature Range | -25°C to +70 °C (-13 to 158°F) |
| Flamability Rating | |
| Housing | UL 94 V-2 |

Drawing

Measurements are shown in millimeters. Multiply by 0.03937 to convert to inches.

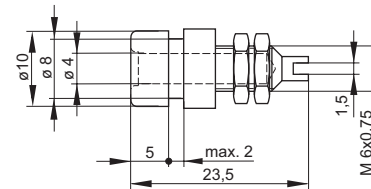
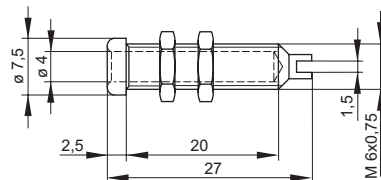

* Please consider derating graph on page 80.