

Test Plugs 4 mm System



Type

LAS S WS
4mm safety banana plug,
stackable, 1000V system,
screw terminal 0.5-1.5mm²
leads.

Pin diameter

4 mm (0.157")

PART NO. / Housing color

- 934099100
- 934099101
- 934099102
- 934099103
- 934099104
- 934099105
- 934099106
- 934099107
- 934099109



LAS S G
4mm safety banana plug,
stackable, 1000V system,
screw terminal 0.5-1.5mm²
leads.

4 mm (0.157")

- 934097100
- 934097101
- 934097102
- 934097103
- 934097104
- 934097105
- 934097106
- 934097107
- 934097109



KST S WS
4mm dual safety plug,
stackable, 1000V system,
nickel plated, 4mm jack.

4 mm (0.157")

- 932200100
- 932200101
- 932200102
- 932200103
- 932200104

Technical Data

Contact Type: spring loaded plug
 Connection Type: screw terminal 0.5-1.5mm²
 Voltage Rating: AC/DC 1000 V
 Measurement Category (IEC61010): CAT II
 Current Rating*: 24A
 Contact Resistance: -

Material Specifications

Plug: nickel plated brass
 Contact Spring: nickel plated copper-beryllium
 Housing: Polyamide

Environmental Conditions

Temperature range: -15°C to +70°C (5 to 158°F)

Flamability Rating

Housing: UL 94 V-2

Contact Type: spring loaded plug
 Connection Type: screw terminal 0.5-1.5mm²
 Voltage Rating: AC/DC 1000 V
 Measurement Category (IEC61010): CAT III
 Current Rating*: 24A
 Contact Resistance: -

Plug: nickel plated brass
 Contact Spring: nickel plated copper-beryllium
 Housing: Polyamide

Temperature range: -15°C to +70°C (5 to 158°F)

Housing: UL 94 V-2

Contact Type: 2x spring loaded plug
 Connection Type: jack Ø 4 mm
 Voltage Rating: AC/DC 1000 V
 Measurement Category (IEC61010): CAT II
 Current Rating*: 32A
 Contact Resistance: 8 mOhm

Plug: nickel plated copper-beryllium
 Contact Spring: nickel plated brass
 Housing: Polyamide

Temperature range: -15°C to +70°C (5 to 158°F)

Housing: UL 94 V-2

Drawing

Measurements are shown in millimeters.
 Multiply by 0.03937 to convert to inches.

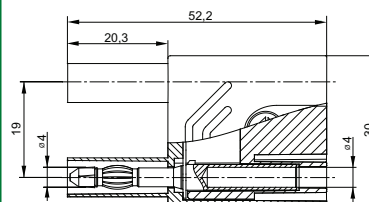
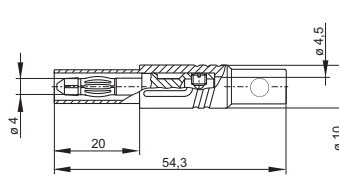
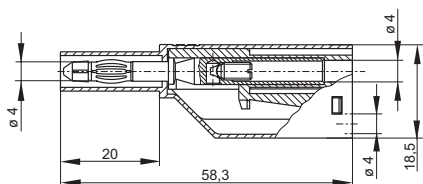

* Please consider derating graph on page 80.