

Test Probes 4 mm Safety System



CE

Type

PRUEF 2700

Safety test probe with dual function. Tip for penetrating insulation and oxide layers and 4 mm diameter pin for insertion in sockets. 4 mm diameter brass socket connection. Connects with safety measuring leads.

Tip diameter

4 mm (0.157 in.)

PART NO. / Housing color

972319100 ●
972319101 ●



CE

PRUEF 2600

Test probe with elastic, shatter-proof insulated sleeve and slender stainless steel tip. Tip for penetration of insulation and oxide layers. 4 mm diameter brass socket connection. Connects with safety measuring leads. Accessory tip protector and IC tap SS 260.

2 mm (0.78 in.)

972317100 ●
972317101 ●

Technical Data

Connection Type	stationary tip
Voltage Rating	fixed socket Ø 4 mm
Measurement Category (IEC61010)	AC/DC 1000 V
Current Rating*	CAT II
Contact Resistance	32 A
Material Specifications	2 mOhm
Tip	nickel plated brass
Connection pin/ socket	nickel plated brass
Contact Spring	-
Housing	PP
Environmental Conditions	
Temperature range	-25 °C to +80 °C (13°F to 176°F)
Flamability Rating	
Housing	UL 94 HB

Connection Type	stationary tip
Voltage Rating	fixed socket Ø 4 mm
Measurement Category (IEC61010)	AC/DC 1000 V
Current Rating*	CAT III
Contact Resistance	1 A
Material Specifications	50 mOhm
Tip	stainless steel
Connection pin/ socket	nickel plated brass
Contact Spring	-
Housing	PP
Environmental Conditions	
Temperature range	-25 °C to +80 °C (13°F to 176°F)
Flamability Rating	
Housing	UL 94 HB

Drawing

Measurements are shown in millimeters. Multiply by 0.03937 to convert to inches.

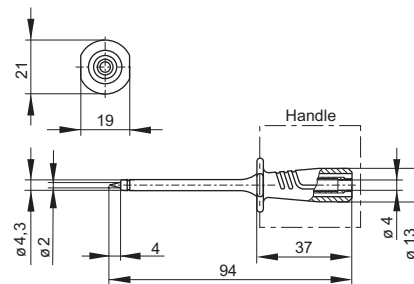
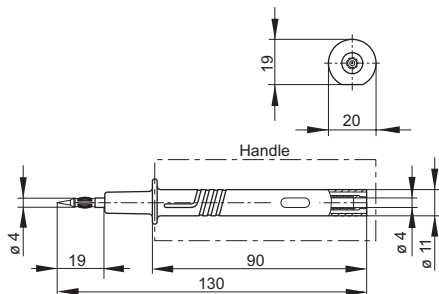

* Please consider derating graph on page 80.