

## Cable Clamps. Eye-bolts & Hardware

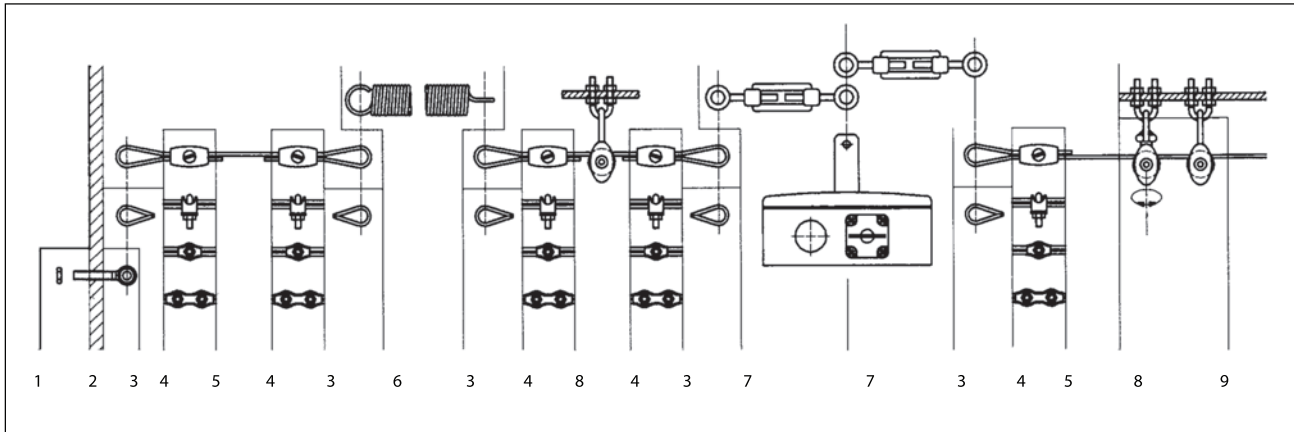

### 1 Nut



Size		Strength class	Art. No.
M 6	DIN 439T2	A2-70	<b>260.0439.090</b>
M 8	DIN 439T2	04	<b>260.0439.187</b>
M 10	DIN 934	8	<b>260.0934.092</b>

Coating: Thick-layer passivated (M 8/M 10), Ros-compliant

### 2 Eye bolt



Size	Strength class	Art. No.
M 10 x 50	4.6	<b>260.0444.076</b>
M 6 x 50	4.6	<b>260.0444.185</b>
M 8 x 50	4.6	<b>260.0444.186</b>

Coating: Thick-layer passivated, RoHs-compliant

### 3 Cable eye stiffener



Size		Art. No.
D 2.5	to DIN 65457	<b>269.6899.013</b>
D 3	to DIN 65457	<b>269.6899.014</b>
D 4	to DIN 65457	<b>269.6899.015</b>
D 5	to DIN 6899B	<b>269.6899.001</b>

Material: Steel strip  
Coating: Blue passivated, RoHs-compliant

### 4 Cable grip

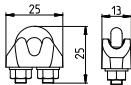

Size	Art. No.
D5	<b>269.0741.002</b>

Material: GTW/steel  
Coating: Yellow chromed, RoHs-compliant

### 4 Cable grip, oval

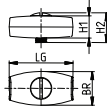

Size	LG	BR	H1	H2	Art. No.
2	28 mm	15 mm	11 mm	13 mm	<b>269.0000.004</b>
3	28 mm	15 mm	12 mm	13 mm	<b>269.0000.005</b>
4	34 mm	20 mm	14 mm	18 mm	<b>269.0000.006</b>

Material: Refined zinc cast alloy  
Coating: Blue passivated, RoHs-compliant

### 4 Cable grip, simplex

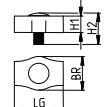

Size	LG	BR	H1	H2	Art. No.
2	15 mm	12 mm	5 mm	11 mm	<b>269.0000.007</b>
3	17 mm	14 mm	6 mm	14 mm	<b>269.0000.008</b>
4	20 mm	17 mm	7 mm	16 mm	<b>269.0000.009</b>

Material: Steel strip  
Coating: Blue passivated, RoHs-compliant

Drawing dimensions in mm

## Cable Clamps, Cable, Springs, Turnbuckles & Pulleys

### 4 Cable grip, duplex

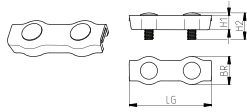

Size	LG	BR	H1	H2	Art. No.
2	35 mm	12 mm	5 mm	11 mm	<b>269.0000.010</b>
3	35 mm	14 mm	6 mm	14 mm	<b>269.0000.011</b>
4	40 mm	17 mm	7 mm	16 mm	<b>269.0000.012</b>

Material: Steel strip  
Coating: Blue passivated, RoHS-compliant

### 5 Cable



Cable Ø / Sheath Ø	Design	Minimum breaking strength	Art. No.
D 1,8/D 5	Similar to DIN 3055	275 kp	<b>369.9100.008</b>
D 2 / D 2.5	to DIN 3055	239 kp	<b>369.9100.024</b>
D 3/D 4	to DIN 3055	538 kp	<b>369.9100.025</b>
D 4/D 5	to DIN 3055	957 kp	<b>369.9100.026</b>

Material: Fiber-core galvanized, strength 1770 N/mm<sup>2</sup>  
Coating: Blue passivated, RoHS-compliant

### 6 Compression spring, eye shape to DIN 1479

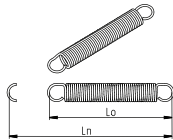

Fo	Fn	R	Lo	Ln	Art. No.
18 N	296 N	1.269 N/mm	188 mm	408 mm	<b>365.2100.331</b>
24 N	354 N	2.466 N/mm	180 mm	314 mm	<b>365.2100.332</b>
13.3 N	153 N	0.694 N/mm	185 mm	387 mm	<b>365.2100.211</b>
35.2 N	450 N	3.490 N/mm	201 mm	319 mm	<b>365.2100.198</b>

Material: Wire to DIN 2076 - 1.4310

### 7 Pull cable spring

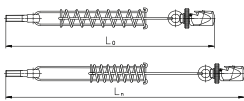

Fn	R	Lo	Ln	Art. No.
218 N	2.1 N/mm	383 mm	487 mm	<b>391.1042.153</b>
335 N	1.9 N/mm	483 mm	653 mm	<b>391.1042.154</b>

Material: Wire to DIN 2076 – 1.4310, cable grip – zinc pressure die-cast alloy, eye bolt to DIN 444 – 4.6  
Coating: Thick-layer passivated (except spring), RoHS-compliant

### 7 Turnbuckle sleeve

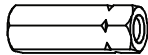

Size	Art. No.
M 6	<b>2601479188</b>
M 8	<b>2601479189</b>

Material: Steel, min. tensile strength 330 N/mm<sup>2</sup>  
Coating: Blue passivated, RoHS-compliant

### 7 Turnbuckle similar to DIN 1480 with two eyes



Open	Art. No.
M 5 x 50	<b>260.1480.016</b>
M 6 x 60	<b>260.1480.017</b>

Material: Steel, forged  
Coating: Blue passivated, RoHS-compliant

### 8 Pulley block, swivel version

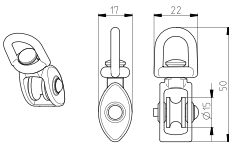

Art. No.
<b>2690000023</b>

Material: Zinc pressure die-cast alloy (pulley polyamide)  
Coating: Blue passivated, RoHS-compliant

### 8 Pulley block, fixed version

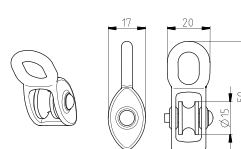

Art. No.
<b>260.0000.022</b>

Material: Zinc pressure die-cast alloy (pulley polyamide)  
Coating: Blue passivated, RoHS-compliant

### 9 Mounting bracket for pulley to DIN 1142



Art. No.
<b>3911751437</b>

Material: Steel  
Coating: Blue passivated, RoHS-compliant

### Deflection pulley ø 75 mm for cable diameter up to 8 mm

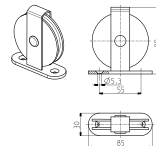

Art. No.
<b>269.0000.051</b>

Material: Steel/polyamide  
Coating: Blue passivated, RoHS-compliant