

# PCB Plug-In Header

3.50 mm Pin Spacing

- Vertical Header
- 11A Current Rating
- Screw Flange

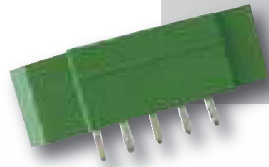

# PVxx-3,50-K

Electrical Ratings		UL E178356		IEC		VDE	
Usergroup	B	C	D				
Rated Voltage	300V	-	300V			160V	
Rated Current	11A	-	11A			8A	
Wire Size	<i>solid</i>	-	-			-	
	<i>stranded</i>	-	-			-	

## Ordering Information (3.50 mm Spacing)

No. Poles	Order #	Length (mm)	Std. Pack
2	PV02-3,50-K	17.4	100
3	PV03-3,50-K	20.9	100
4	PV04-3,50-K	24.4	50
5	PV05-3,50-K	27.9	50
6	PV06-3,50-K	31.4	50
7	PV07-3,50-K	34.9	50
8	PV08-3,50-K	38.4	50
9	PV09-3,50-K	41.9	50
10	PV10-3,50-K	45.4	50
11	PV11-3,50-K	48.9	50
12	PV12-3,50-K	52.4	50
13	PV13-3,50-K	55.9	20
14	PV14-3,50-K	59.4	20
15	PV15-3,50-K	62.9	20
16	PV16-3,50-K	66.4	20
17	PV17-3,50-K	69.9	20
18	PV18-3,50-K	73.4	20
19	PV19-3,50-K	76.9	20
20	PV20-3,50-K	80.4	20
21	PV21-3,50-K	83.9	20
22	PV22-3,50-K	87.4	20
23	PV23-3,50-K	90.9	20
24	PV24-3,50-K	94.4	20

## Dimensions (mm)

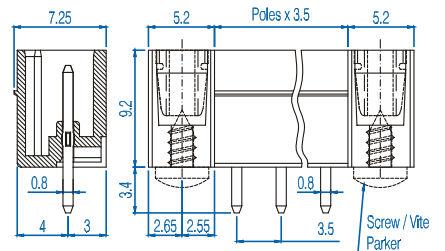

## Drilling Diagram

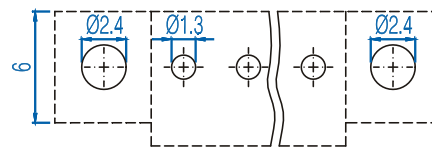

### Material Specifications

Solder Tab	Tin-Plated Copper Alloy
Insulating Material	Polyamide
Flammability Class	V0 UL94
Operating Temperature	-30°C - +105°C

### Installation Data

PCB Hole Size	1.3 mm
Flange Thread	M2.5
Recommended	Parker
Mounting Screw	ISO1481-ST 2,2x4,5(6,5) C

### Mating Plugs

SHxx-3,50-K	SVFxx-3,50-K	SVPxx-3,50-K
-------------	--------------	--------------