

Test Probes 4 mm Safety System



CE

PRUEF 2600 C2

Test probe shatter - proof insulating sleeve and slender stainless steel tip. Tip for penetration of insulation and oxide layers. 4mm diameter brass socket connection. Connection with safety measuring leads. Accessory (optional): protector and IC - tap SS 260

Tip diameter 2 mm (0.079 in.)

PART NO. / Housing color
972327100 ●
972327101 ●



SS 260

Tip protection and IC tap. Clipping onto the PRUEF 2, PRUEF 2 S and PRUEF 2600 C2 test probe covers the needle tip and provides protection against injury. Contact is made with ICs without short circuiting or slipping off.

-
973865001 ○



CE

PRUEF 2610 FT

Test probe with insulated sleeve and slender, sprung stainless steel tip. This allows a constant pressure to be applied without the tip slipping off the component, even in the smallest measuring points. 4 mm diameter brass socket connection.

0.75 mm (0.029 in.)

972318100 ●
972318101 ●

Technical Data

Connection Type	stationary tip	-	spring-loaded tip
Voltage Rating	fixed socket Ø 4 mm	-	fixed socket Ø 4 mm
Measurement Category (IEC61010)	AC/DC 1000V	-	AC/DC 1000 V
Current Rating*	CAT II	-	CAT II
Contact Resistance	1 A	-	1 A
Material Specifications	50 mOhm	-	50 mOhm
Tip	stainless steel	-	stainless steel
Connection pin/ socket	nickel plated brass	-	nickel plated brass
Contact Spring	-	-	-
Housing	PP	-	PP
Environmental Conditions		-	
Temperature range	-20°C to +60°C (-4°F to 140°F)	-	-25 °C to +80 °C (13°F to 176°F)
Flamability Rating		-	
Housing	UL 94 HB	-	UL 94 HB

Drawing

Measurements are shown in millimeters.
Multiply by 0.03937 to convert to inches.

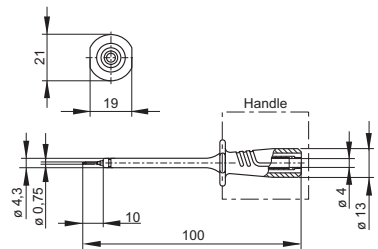
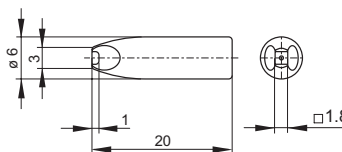
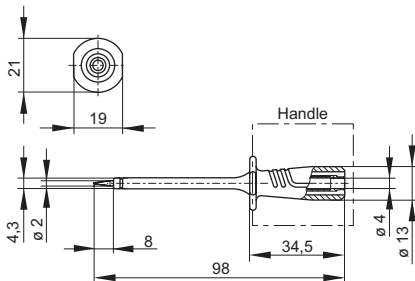

* Please consider derating graph on page 80.