

PCB Terminal Block

3.81 mm Pin Spacing

- Board Mount PCB
- 12A Current Rating
- Height 12.6mm
- Modular / stackable, no dovetail version



MVS13xx-3,81-V

Front Wire Entry

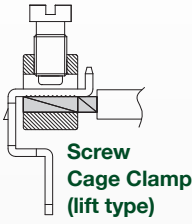

Electrical Ratings

Usergroup	B	C	D	
Rated Voltage	300V	-	300V	130V
Rated Current	12A	-	12A	17.5A
Wire Size	<i>solid</i> 30-16 AWG <i>stranded</i> 30-16 AWG	-	30-16 AWG 30-16 AWG	0.25mm ² - 1.5mm ² 0.25mm ² - 1.5mm ²



Ordering Information

No. Poles	Length (mm)	Std. Pack	Order # - Modular	Order # - No Dovetails
2	7.62	200	MVS-132	MVS132-3,81-V-L
3	11.43	200	MVS-133	MVS133-3,81-V-L
4	15.24	200	MVS-134	MVS134-3,81-V-L
5	19.05	200	MVS-135	MVS135-3,81-V-L
6	22.86	200	MVS-136	MVS136-3,81-V-L
7	26.67	100	MVS-137	MVS137-3,81-V-L
8	30.48	100	MVS-138	MVS138-3,81-V-L
9	34.29	100	MVS-139	MVS139-3,81-V-L
10	38.10	100	MVS-1310	MVS1310-3,81-V-L
11	41.91	100	MVS-1311	MVS1311-3,81-V-L
12	45.72	100	MVS-1312	MVS1312-3,81-V-L
13	49.53	100	MVS-1313	MVS1313-3,81-V-L
14	53.34	100	MVS-1314	MVS1314-3,81-V-L
15	57.15	100	MVS-1315	MVS1315-3,81-V-L
16	60.96	100	MVS-1316	MVS1316-3,81-V-L
17	64.77	100	MVS-1317	MVS1317-3,81-V-L
18	68.58	100	MVS-1318	MVS1318-3,81-V-L
19	72.39	100	MVS-1319	MVS1319-3,81-V-L
20	76.20	100	MVS-1320	MVS1320-3,81-V-L
21	80.01	100	MVS-1321	MVS1321-3,81-V-L
22	83.82	100	MVS-1322	MVS1322-3,81-V-L
23	87.63	100	MVS-1323	MVS1323-3,81-V-L
24	91.44	100	MVS-1324	MVS1324-3,81-V-L

Material Specifications

Clamp	Nickel-Copper
Solder tab	Tin-Plated Copper
Screw	Galvanized Steel
Insulating Material	Polyamide
Flammability Class	V0 UL94
Operating Temperature	-30°C - +105°C

Installation Data

Screw Size	M2
Torque	0.2Nm (1.8 lb.in.)
Stripping Length	max. 6mm
Clamp Opening	1.8 x 2.6mm
PCB Hole Size	1.3mm

Dimensions (mm)

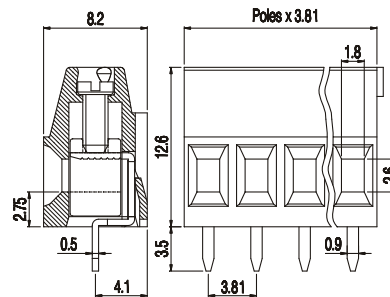

Drilling Diagram

