

## PCB Terminal Block

5.00 mm Pin Spacing

- Board Mount PCB
- 20A Current Rating
- Height 29.5mm
- Modular
- High Profile



# MMT25xx-5-V

Front Wire Entry, High Profile

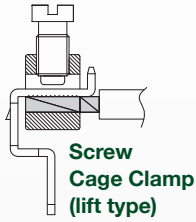

### Electrical Ratings

	UL E178356			IEC	VDE N.40019705
	B	C	D		
Usergroup	B	C	D	-	-
Rated Voltage	300V	-	300V	450V	-
Rated Current	20A	-	20A	20A	-
Wire Size	<i>solid</i>	30-12 AWG	-	30-12 AWG	0.25mm <sup>2</sup> - 4.0mm <sup>2</sup>
	<i>stranded</i>	30-12 AWG	-	30-12 AWG	0.25mm <sup>2</sup> - 2.5mm <sup>2</sup>

### Ordering Information

No. Poles	Length (mm)	Std. Pack	Order #
2	10	100	MMT252-5,00-V
3	15	100	MMT253-5,00-V
4	20	100	MMT254-5,00-V
5	25	100	MMT255-5,00-V
6	30	100	MMT256-5,00-V
7	35	100	MMT257-5,00-V
8	40	100	MMT258-5,00-V
9	45	100	MMT259-5,00-V
10	50	100	MMT2510-5,00-V
11	55	100	MMT2511-5,00-V
12	60	100	MMT2512-5,00-V

### Material Specifications

Clamp	Nickel-Copper
Solder tab	Tin-Plated Copper
Screw	Galvanized Steel
Insulating Material	Polyamide
Flammability Class	V0 UL94
Operating Temperature	-30°C - +105°C

### Installation Data

Screw Size	M3
Torque	0.5Nm (4.5 lb.in.)
Stripping Length	max. 7.5mm
Clamp Opening	2.8 x 2.8mm
PCB Hole Size	1.3mm

### Dimensions (mm)

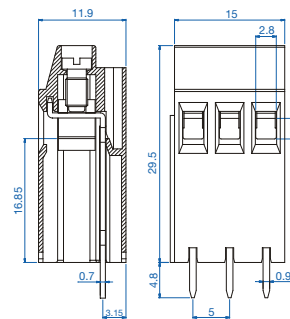

### Drilling Diagram

