

# PCB Terminal Block

10.16 mm Pin Spacing

- Board Mount PCB
- 20A Current Rating
- Height 10.2mm
- Modular



# MBES15xx-10,16-V

Front Wire Entry

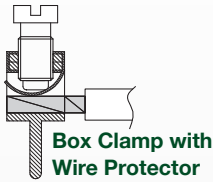

### Electrical Ratings

Usergroup	B	C	D	
Rated Voltage	300V	300V	600V	1000V
Rated Current	20A	20A	20A	24A
Wire Size	<i>solid</i> 30-14 AWG <i>stranded</i> 30-14 AWG	30-14 AWG 30-14 AWG	30-14 AWG 30-14 AWG	0.25mm <sup>2</sup> - 2.5mm <sup>2</sup> 0.25mm <sup>2</sup> - 1.5mm <sup>2</sup>



### Ordering Information

No. Poles	Length (mm)	Std. Pack	Order #
2	15.24	100	MBES152-10,16-V
3	25.40	100	MBES153-10,16-V
4	35.56	100	MBES154-10,16-V
5	45.72	100	MBES155-10,16-V
6	55.88	100	MBES156-10,16-V
7	66.04	100	MBES157-10,16-V
8	76.20	100	MBES158-10,16-V
9	86.36	100	MBES159-10,16-V
10	96.52	100	MBES1510-10,16-V
11	106.68	100	MBES1511-10,16-V
12	116.84	100	MBES1512-10,16-V

### Material Specifications

Clamp	Tin-Plated Copper
Solder tab	Tin-Plated Copper
Screw	Galvanized Steel
Insulating Material	Polyamide
Flammability Class	V0 UL94
Operating Temperature	-30°C - +105°C

### Installation Data

Screw Size	M2.5
Torque	0.4 Nm (3.6 lb.in.)
Stripping Length	max. 6.5mm
Clamp Opening	2.6 x 2.4mm
PCB Hole Size	1.5mm

### Dimensions (mm)

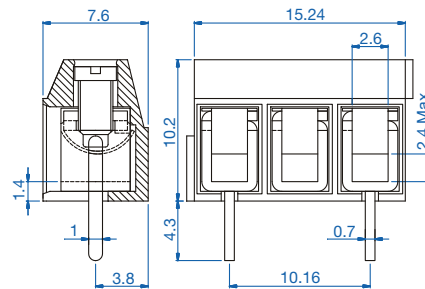

### Drilling Diagram

