

Mini-level float switches

Description **MSK1-PP-R1/8-U 0041**

Article number **6895411002**

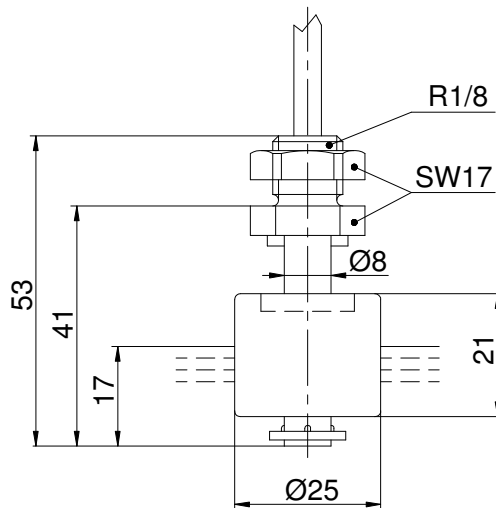

Performance diagram
(maximum data)

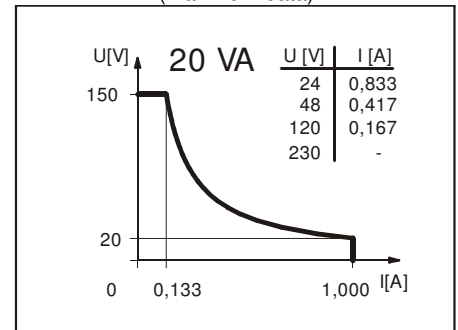

Wiring diagram
(matching to the drawing)

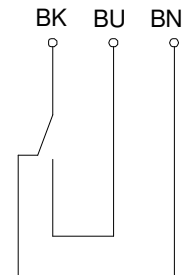

Electrical data

Reed contact	max. switching voltage	150 V
	max. switching current	1 A
	max. switching capacity	20 VA
	mechanical life	10 ⁷ to 10 ⁹ switches depending on the load
Switching element	1 change over contact, falling level	
Direction category	AC-22A and DC-22A acc to DIN VDE 0660 T107	
Standard	acc to DIN VDE 0660 T200	

Mechanical data

box material	PP
Hexagon nut material	PP
Switching tube material	PP
-density	about 0,54 g/cm ³ ±10%
Grip screw material	PP
Ambiente air temperature	-5°C bis +60°C
Medium temperature	-5°C bis +60°C
Connection	1m cable, PVC, 3x 0,34 mm ²
Protection type	IP 65 acc to DIN VDE 0470 T1

General details

Reproducibility of switching points is ±0,05mm based on the same geometrical conditions as of a switch device.
 The measures of the switching points refer to a fluid-tight of 1 g/cm³.
 The tolerance of the switching points is ±2mm
 Pay attention to the contact protection, when switching inductive loads. Maximum data must not be exceeded!

Subject to change without notice.

Date of issue : 27.04.2009 / Page 1 of 1
 Document : 6895411002_01_en / Last update : 1