

Technical Data

Float Switch

Standard float switches

Description **MAN-713 KSS TEMP 0336**

Article number **6815125115**

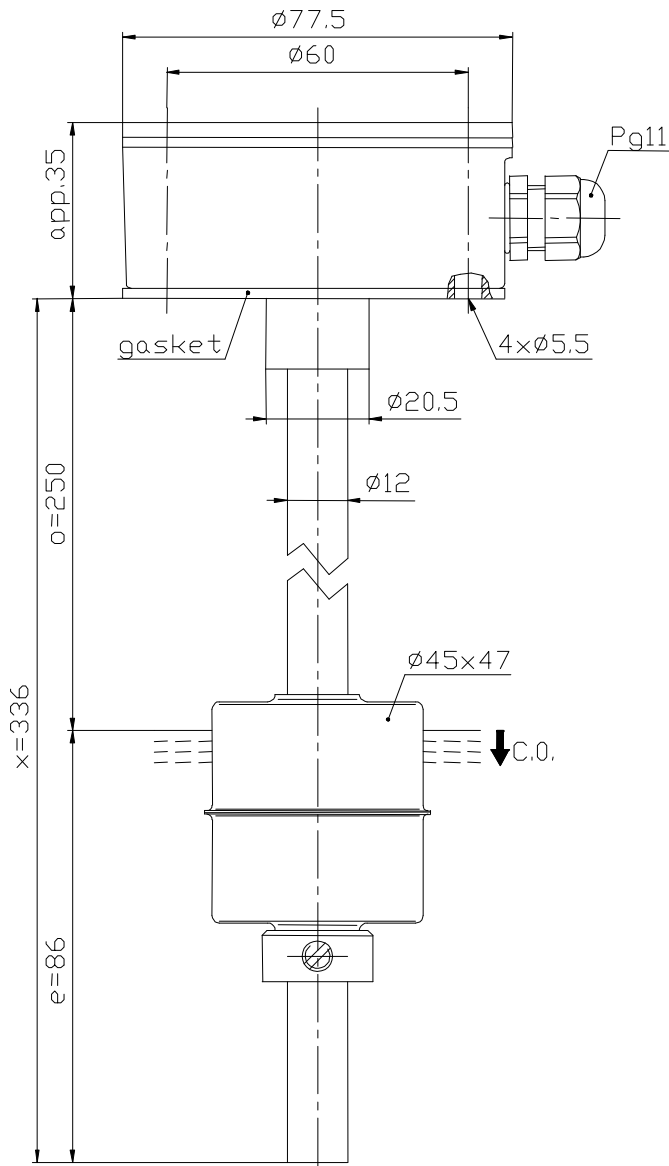

Performance diagram (maximum data)

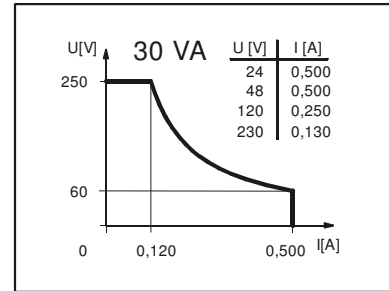

Wiring diagram (without liquid)

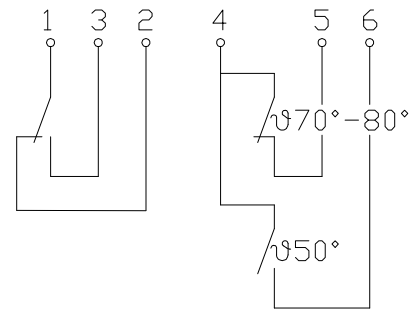

Subject to change without notice.

Date of issue : 31.01.2007 / Page 1 of 2
Document : 6815125115_en.doc / Last update : 1

Standard float switches

Description **MAN-713 KSS TEMP 0336** Article number **6815125115**

Electrical data

Reed contact	max. switching voltage	250 V
	max. switching current	0,5 A
	max. switching capacity	30 VA
	mechanical life	10 ⁷ to 10 ⁹ switches depending on the load
Switching element		1 change over contact, falling level
		2 temperature switches
		1 normally closed contact 70 °C to 80 °C
		1 normally open contact 50 °C
Temperature switches: stress min.		50 mA
	stress max.	2,5 A
Direction category		AC-22A and DC-22A acc to DIN VDE 0660 T107
Standard		acc to DIN VDE 0660 T200

Mechanical data

Terminal box material	GK-AISI12 (3.2581.02)
Switching tube material	X6CrNiMoTi 17 12 2 (1.4571)
Float material	X6CrNiMoTi 17 12 2 (1.4571)
-density	about 0,7 g/cm ³ ±10%
-depth of immersion	32 mm ±2 mm (to a fluid-density of 1 g/cm ³)
Adjusting ring material	X6CrNiMoTi 17 12 2 (1.4571)
Gasket material	NBR
Ambient air temperature	-5 °C to +70 °C
Liquid temperature	-5 °C to +70 °C
Connection	connection block inside the terminal box
Protection type	IP 65 acc to DIN VDE 0470 T1
Max. pressure	15 bar

General details

Repeatability of switching points is ±0,05mm based on the same geometrical conditions as of a switch device.

The measures of the switching points refer to a fluid-density of 1 g/cm³.

The tolerance of the switching points is ±2mm

Pay attention to the contact protection, when switching inductive loads. Maximum data must not be exceeded!